

oodle™

Introduction

ROCKER BASE

oodle rocker base was designed to offer two distinct sitting positions for students. The first, active motion provided by a convex surface or “engaged position.” Second, oodle let’s students sit with out motion, “dis-engaged position.”



Dis-Engaged Position
Student Sits Flat with No Motion



Engaged Position
Student Sits with Motion

STOOL SECTIONS

Each oodle stool comes standard with three 6.5 inch sections. These sections combine to create different seating positions for students. Each stool features a unique stool to stool locking mechanism, in addition each stool pairs with the rocker base components.



oodle stool stacking sections.
Stack them one, two or three sections high.

INSERTING ROCKER BASE

Engaged Position

Student Sits with Motion

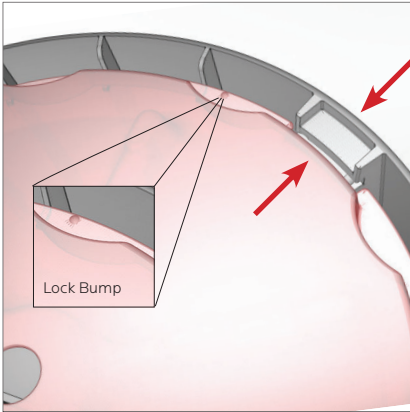

Place rocker base into stool with convex side up. Align base's lock mechanism with the stool's corresponding lock as shown.

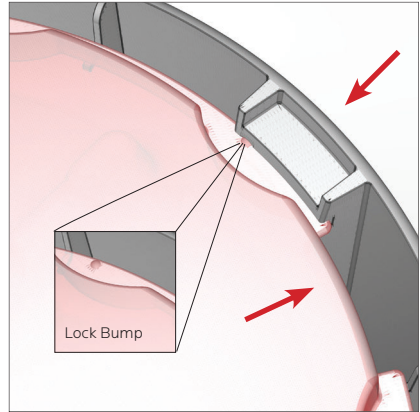

Using the ribbed outer ring for leverage; Rotate **Clockwise** to securely lock rocker base into Stool in active position. User will feel lock bump engage with stool.

Dis-Engaged Position

Student Sits Flat with No Motion

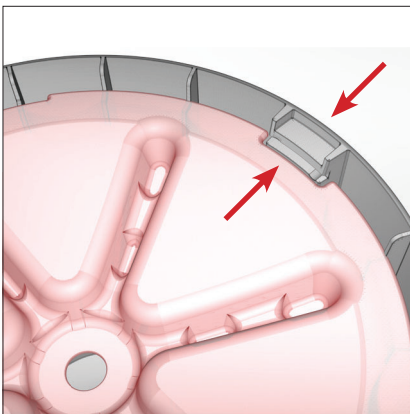

Place rocker base into stool. Align base's lock mechanism with the stool's corresponding lock as shown.

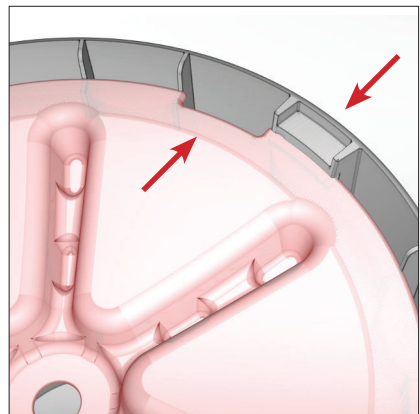

Using the grooves for leverage; Rotate **Counter-Clockwise** to securely lock rocker base into Stool. User will feel lock bump engage.



Handles must be **ALIGNED** to engage locks between stool sections. Rotate stool to lock between sections.



STACKING AND LOCKING SECTIONS

How to stack oodle

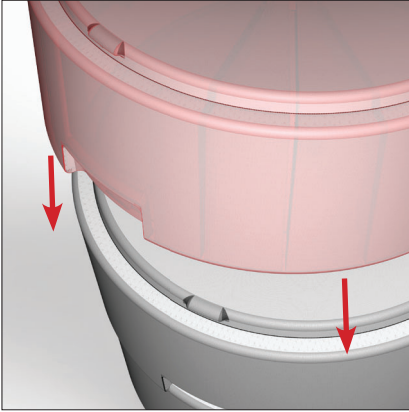

Place section on top of other section off center from handle as shown. The between stool locking mechanisms are located at each handle.

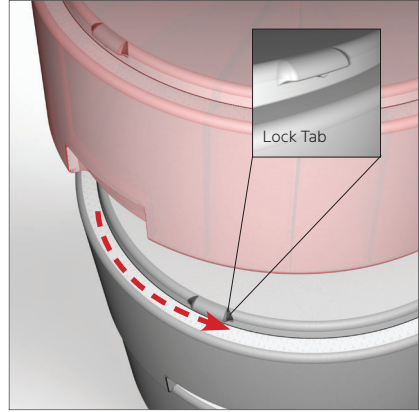

Top section (red) placed off center from Lock tab of section below. Top section rotates to engage stool-to-stool locking mechanism. Handles are aligned once lock is engaged.

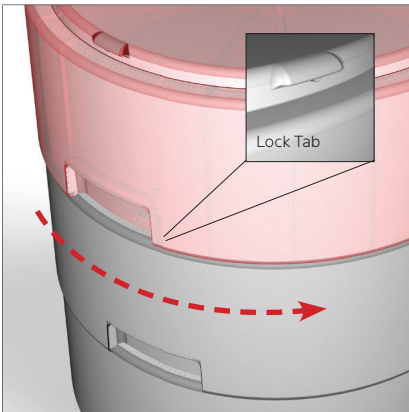

With each section positioned correctly, rotate the top stool clockwise to engage stool-to-stool locking mechanism onto locking tab. User should feel lock engage, handles are in perfect alignment.

