

# Assembly Instructions

## Flowform Adjustable Height Tables



If you have damaged or missing components,  
please contact customer service at 1-800-328-1061

# Hardware and Components

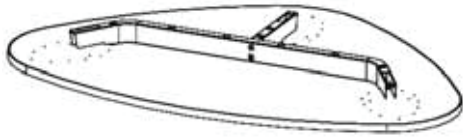

ORBIT TOP WITH FRAME  
(MAY APPEAR DIFFERENT THAN SHOWN)  
QTY. 1

OR



ORBIT TOP, NO FRAME  
(MAY APPEAR DIFFERENT THAN SHOWN)  
QTY. 1

**PACK #60001**  
**( 3 TO 4 LEGS PER TABLE )**



ORBIT LEG WITH GLIDE  
QTY. 1



NYLON GLIDE TIP  
QTY. 1



FELT GLIDE TIP  
QTY. 1



#10 X 3/4" HI-LO WOOD  
SCREW  
QTY. 14



5/16"-18 X 1/2" BOLT  
QTY. 2



3/8"-16 X 5/8" SET SCREW  
QTY. 2



3/16" ALLEN WRENCH  
QTY. 1



ORBIT LEG FOR CASTER  
QTY. 1



#10 X 3/4" HI-LO WOOD  
SCREW  
QTY. 14



5/16"-18 X 1/2" BOLT  
QTY. 2



3/8"-16 X 5/8" SET SCREW  
QTY. 2



3/16" ALLEN WRENCH  
QTY. 1



2" CASTER 7/16" STEM W/LOCK  
(PN: 60021)  
QTY. 1

## Special Notes:

- TOOLS REQUIRED:
  - Drill w/#2 Phillips driver bit, or #2 Phillips head screwdriver.
- Check that all components are accounted for and undamaged before assembling.
- Please assemble the product in a clean and dry area.
- You may need another person to help assemble the product. Team lifting may be required.
- Clean the product with a mild cleaner and a damp cloth.

# Assembly Instructions

- 1. FOR LEGS WITH GLIDES:** Insert either the Nylon or Felt Tip into the Glide. Press down on tip until it snaps into place.

**Helpful Hint:** It is recommended that the Nylon Glide Tip is used for carpeted areas and the Felt Glide Tip is used for hard surfaces such as hardwood floors.

**NOTE:** To remove Glide Tip, use a flat-head screwdriver inserted into the notch in the back of the Glide to pry up the Glide Tip.

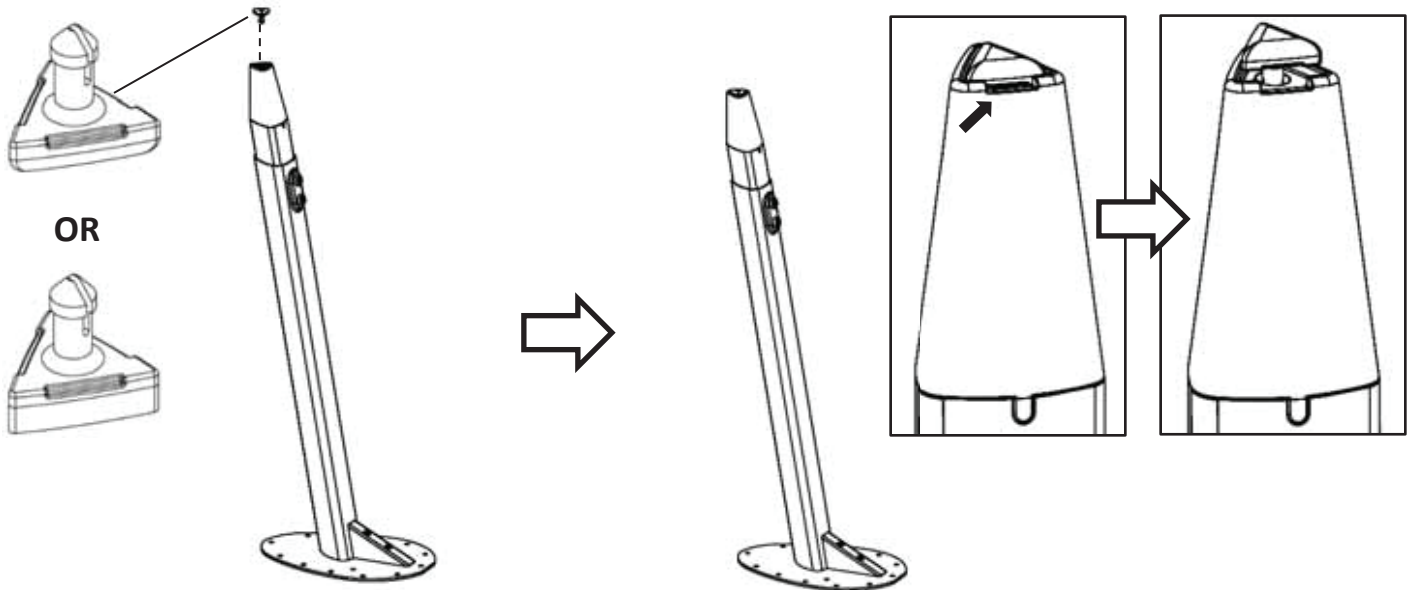

- 2. FOR LEGS WITH CASTERS:** Insert stem of caster into Casket Socket on leg. Press down until the caster stem is fully inserted into the leg.

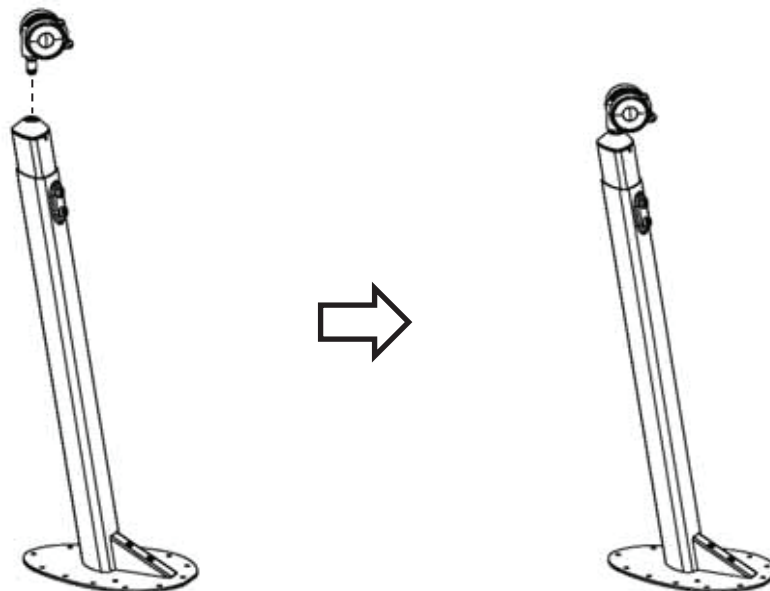

3. **FOR FRAMELESS TABLES:** Lay top down on a clean smooth surface that will not harm the top finish. Underside of top should be exposed. **Top may be heavy, team lifting is encouraged.**

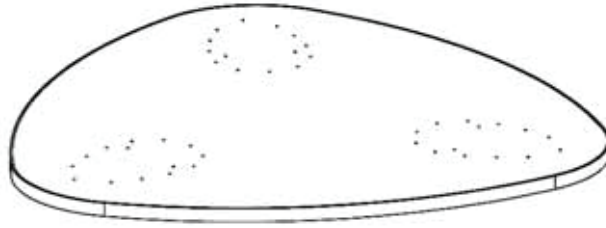

4. Align leg mounting plate holes with pilot holes on underside of top. Install all 14 of the #10 x 3/4" Hi-Lo Wood Screws to secure the leg to the top.

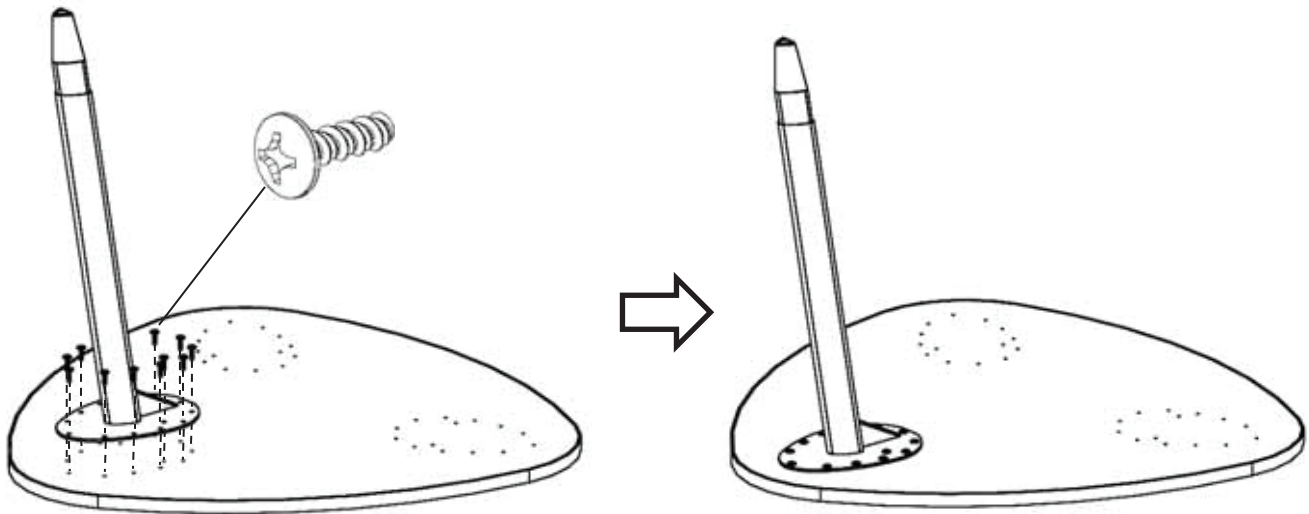

5. Next install the 5/16"-18 x 1/2" Bolts into leg gusset.  
**Helpful Hint:** These bolts are used on current and future accessories.

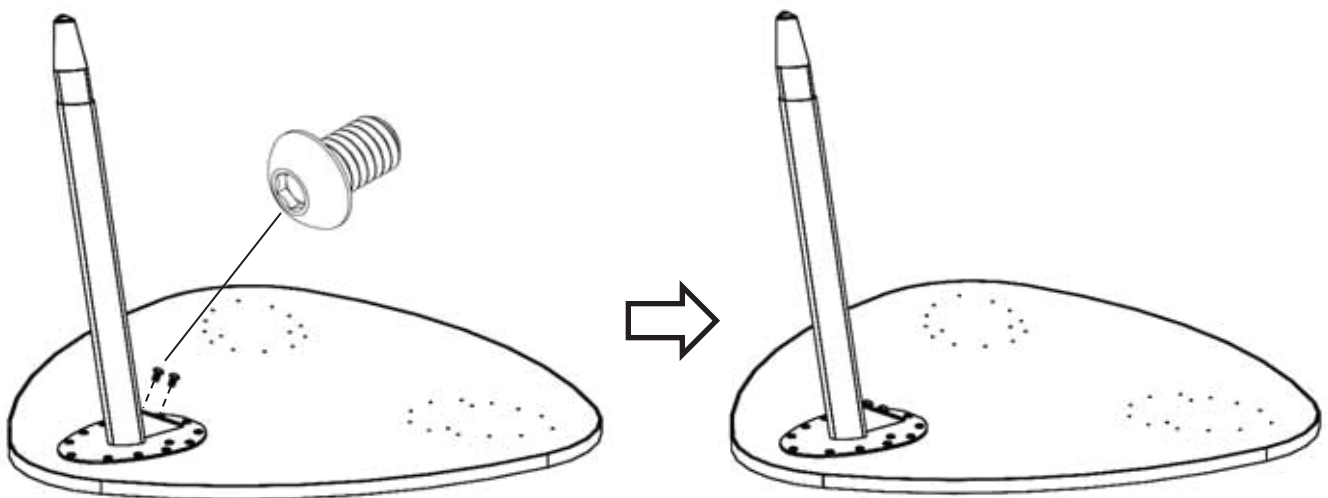

6. Install the other legs as previously shown.

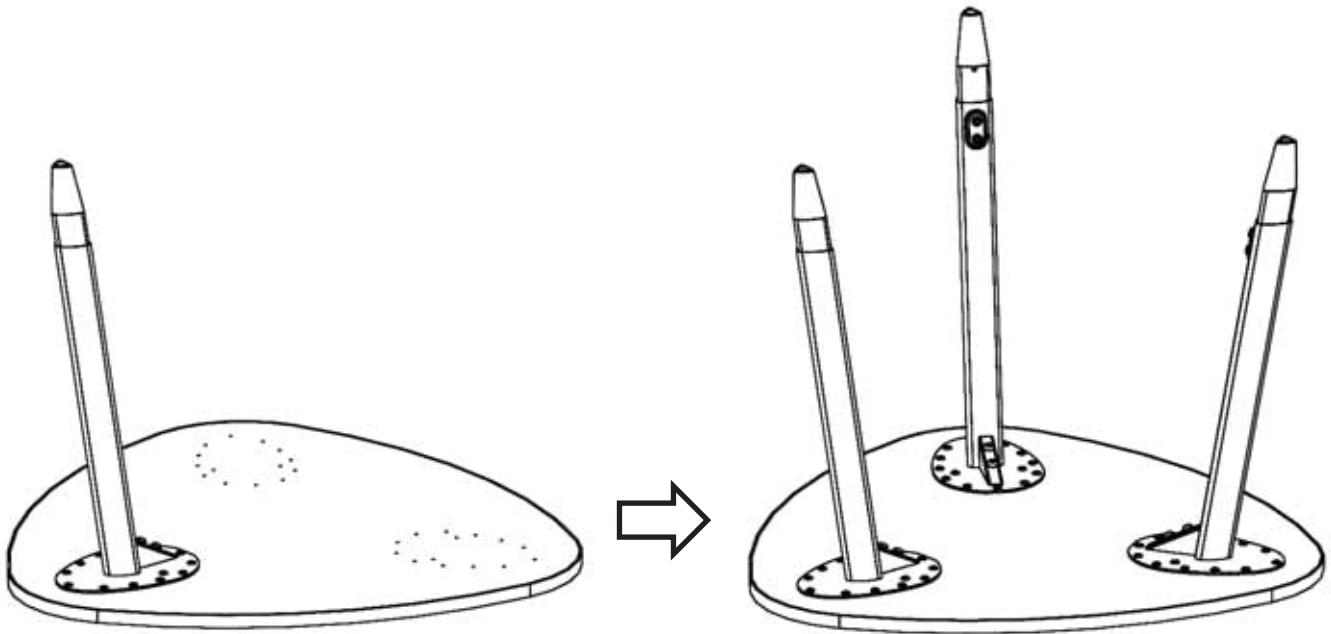

7. **FOR TABLES WITH FRAMES:** Lay top down on a clean smooth surface that will not harm the top finish. Underside of top and frame should be exposed. **Top may be heavy, team lifting is encouraged.**

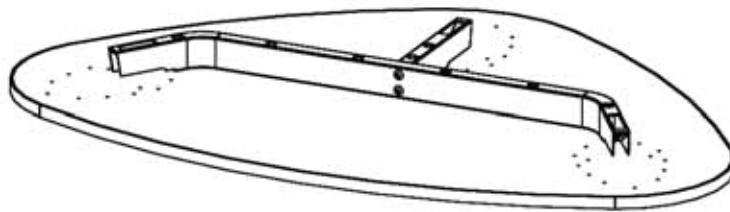

8. Slide gusset of leg into frame and align leg mounting plate holes with pilot holes on underside of top.

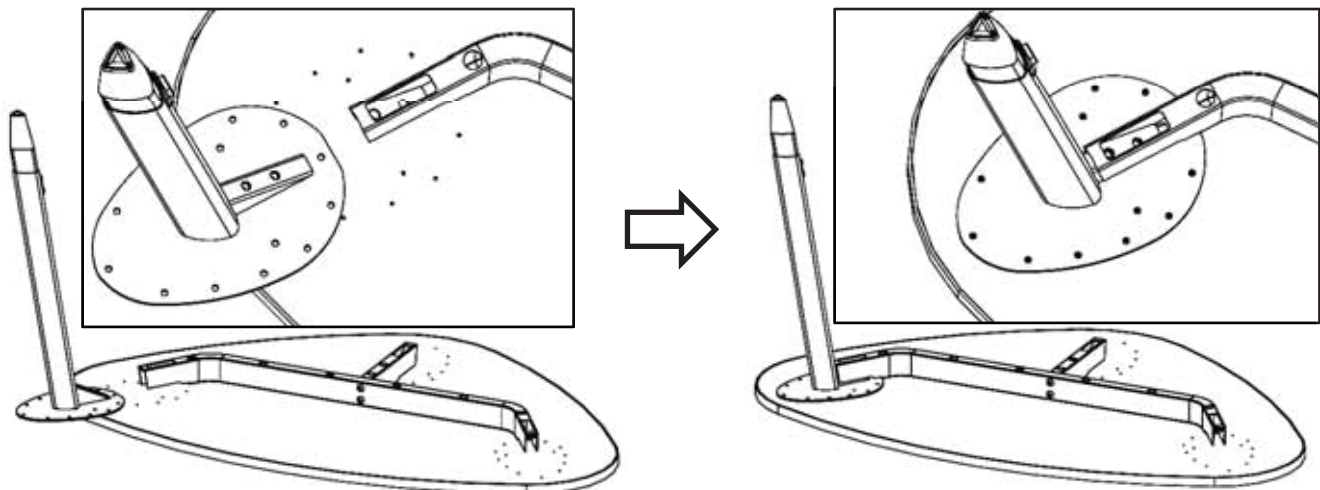



9. Install 13 of the #10 x 3/4" Hi-Lo Wood Screws to secure the leg to the top leaving out one of the screws as the hole is covered by the frame.

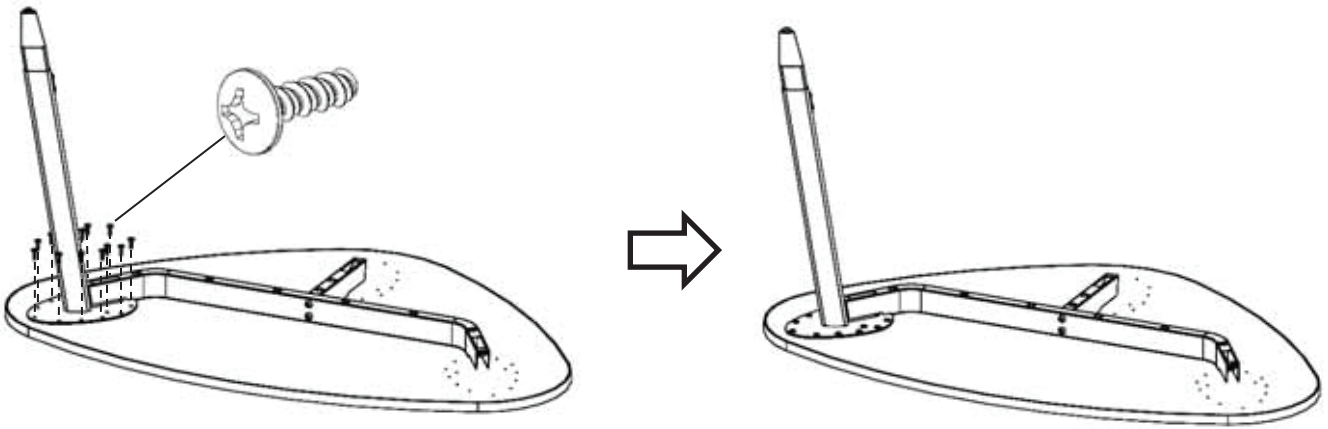

10. Next install the 5/16"-18 x 1/2" Bolts to connect the frame to the leg gusset.

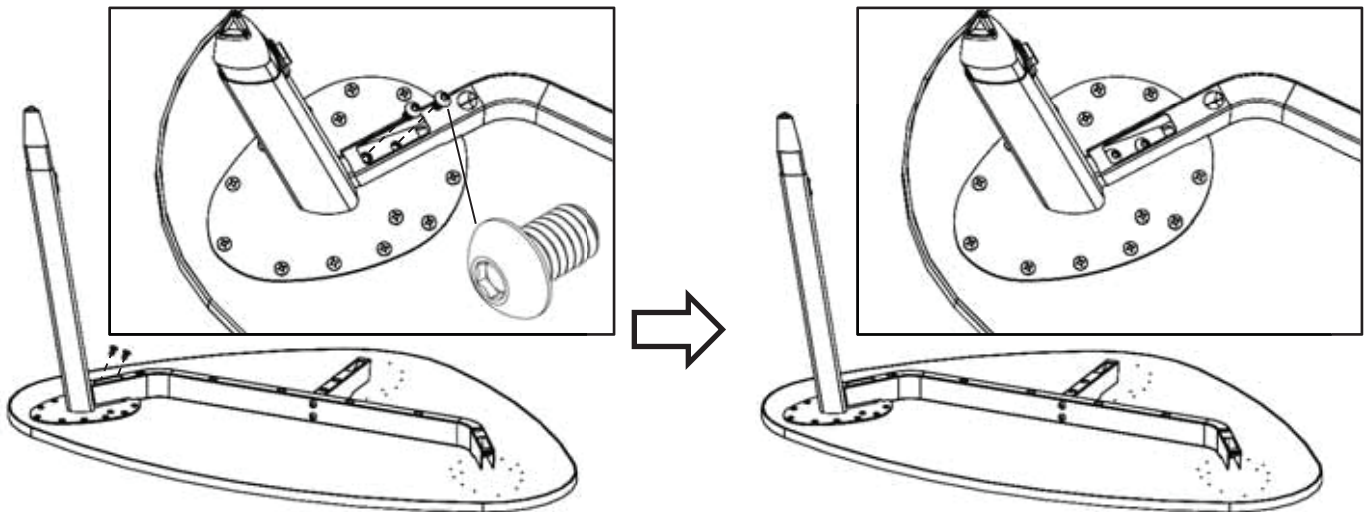

11. Install the other legs as previously shown.

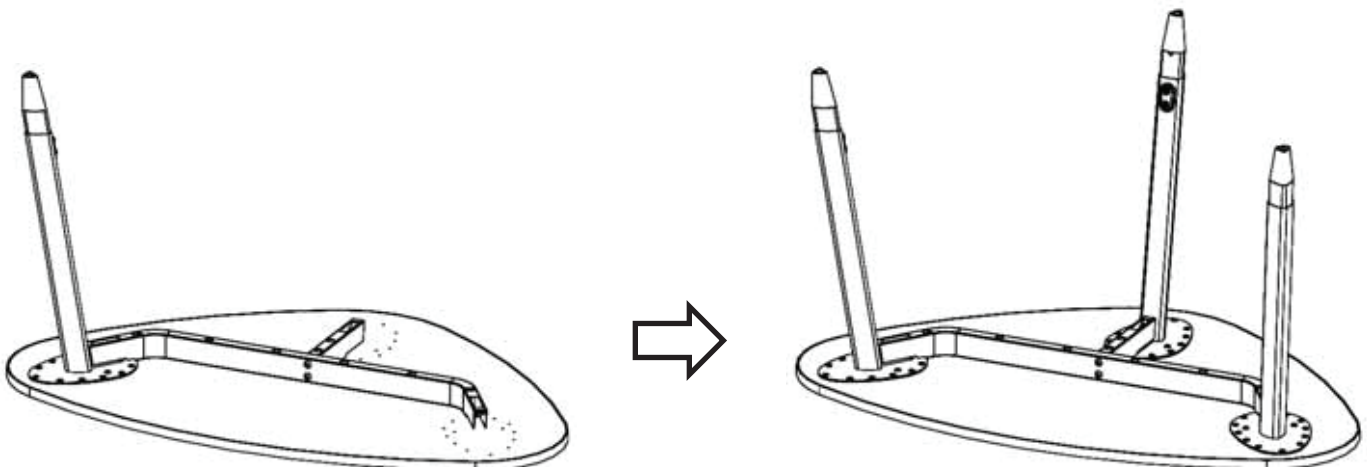

**12. TO ADJUST LEG HEIGHT:** Remove the two 3/8"-16 x 5/8" set screws, adjust leg to the desired height and reinstall the two set screws. Repeat this for all legs.

**Helpful Hint:** The spacing between each hole in the inner leg is for 1" of adjustment.

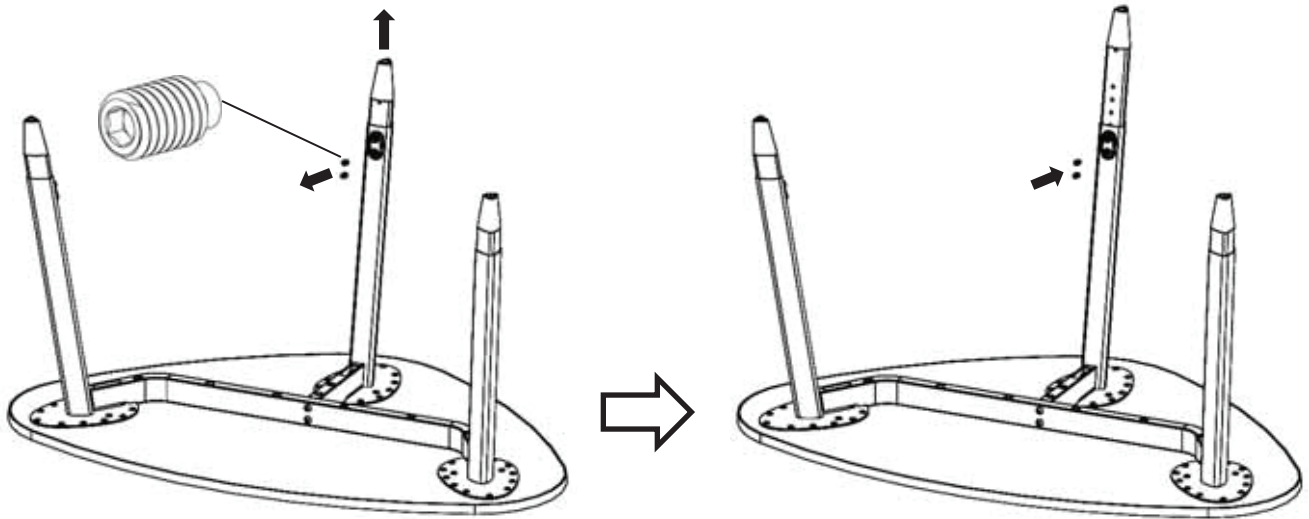

**13.** Lift table and flip to the upright position. You may need a partner to team lift the heavier tables.

**Helpful Hint:** If equipped with casters, lock all casters to prevent unexpected rolling when table legs touch down.

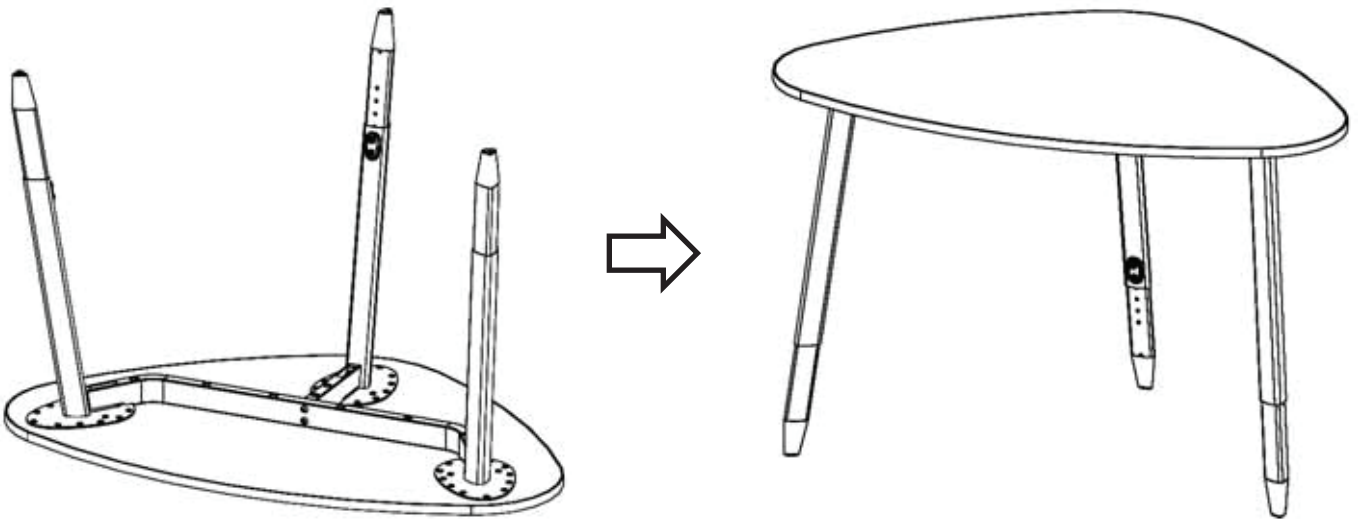

**ASSEMBLY COMPLETE**