



Smith System®

Specification Sheet

WWW.SMITHSYSTEM.COM

Flowform™ Learn Lounge Flowform Learn Lounge Ottoman & Surface

MODEL#: 56019



OVERVIEW

The Flowform Learn Lounge Ottoman + Surface adds a new level of comfort and flexibility to spaces. Easily rearrange into limitless configurations for collaboration. Pairs well with the other pieces in the Flowform Learn Lounge suite

MATERIALS

The structure is constructed of plywood frame which is made from Sustainable Forestry Initiative (SFI) certified responsible wood sources. The seating pad is made from high density foam meeting CAL 117 standards and contains no added flame retardant chemicals. Comes with reversible nylon & felt glides with the ability to choose from many laminate and edge banding colors.

The fabric is Designtex Alphabet 100% vinyl, with a 1,000,000 D.R. Durability rating. The fabric is highly durable and is easily cleanable with a 10:1 Water:Bleach mixture.

WEIGHT CAPACITY: 300 lbs

DESIGNTEX

| | |
|------------------|-----------------------------|
| PATTERN | Alphabet |
| CONTENT | 100% Vinyl |
| BACKING | Polyester, Knit |
| FLAME RESISTANCE | CA Bulletin 117-2013 |
| DURABILITY | 1,000,000 D.R. |
| MAINTENANCE | W: Bleach Cleanable (10:1) |
| FINISH | Advanced Protective Topcoat |

DIMENSIONS

| Model | Description | D" | H" | WT |
|-------|-------------------|---------|-------|----|
| 56019 | Ottoman & Surface | 26 dia. | 16.75 | 30 |

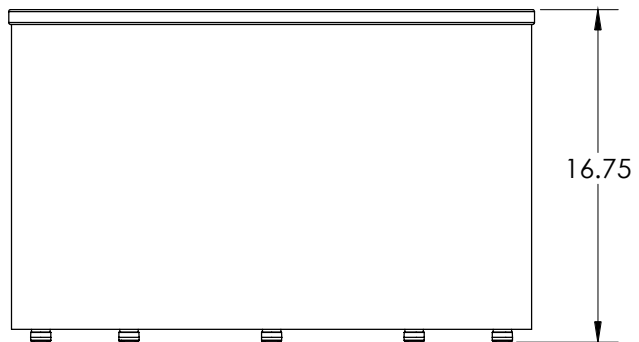
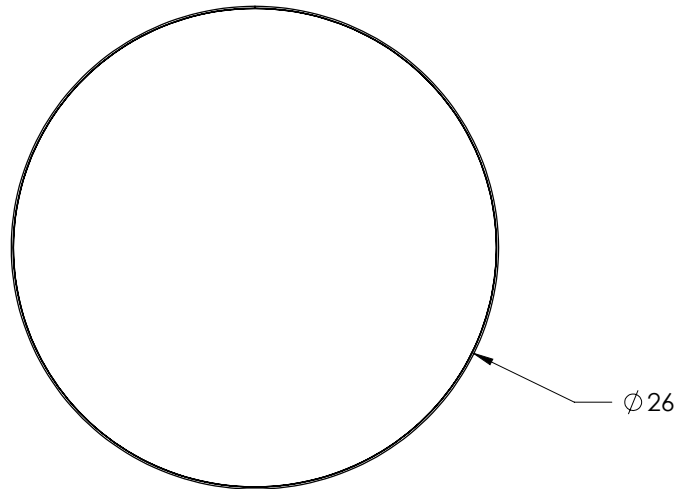

STANDARD LAMINATE OPTIONS

Want to specify a different laminate?

No problem. If you have 20 or more tops of the same color -60 or -38 there is no upcharge. Have 20 or less? We can quote for you with the Wilsonart code and finish style. We can specify other laminates - call to inquire and get a quote.

LAMINATE AND MATCHING 3MM EDGE OPTIONS



VINYL COLOR OPTIONS

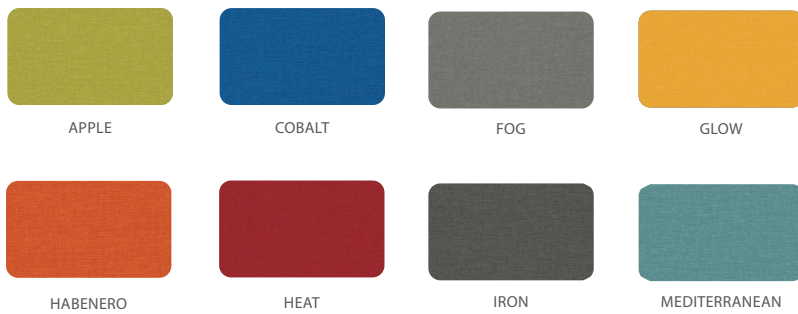

VINYL COLOR OPTIONS WITH LEAD TIME

