

Assembly Instructions

Flowform Soft Seating Glides

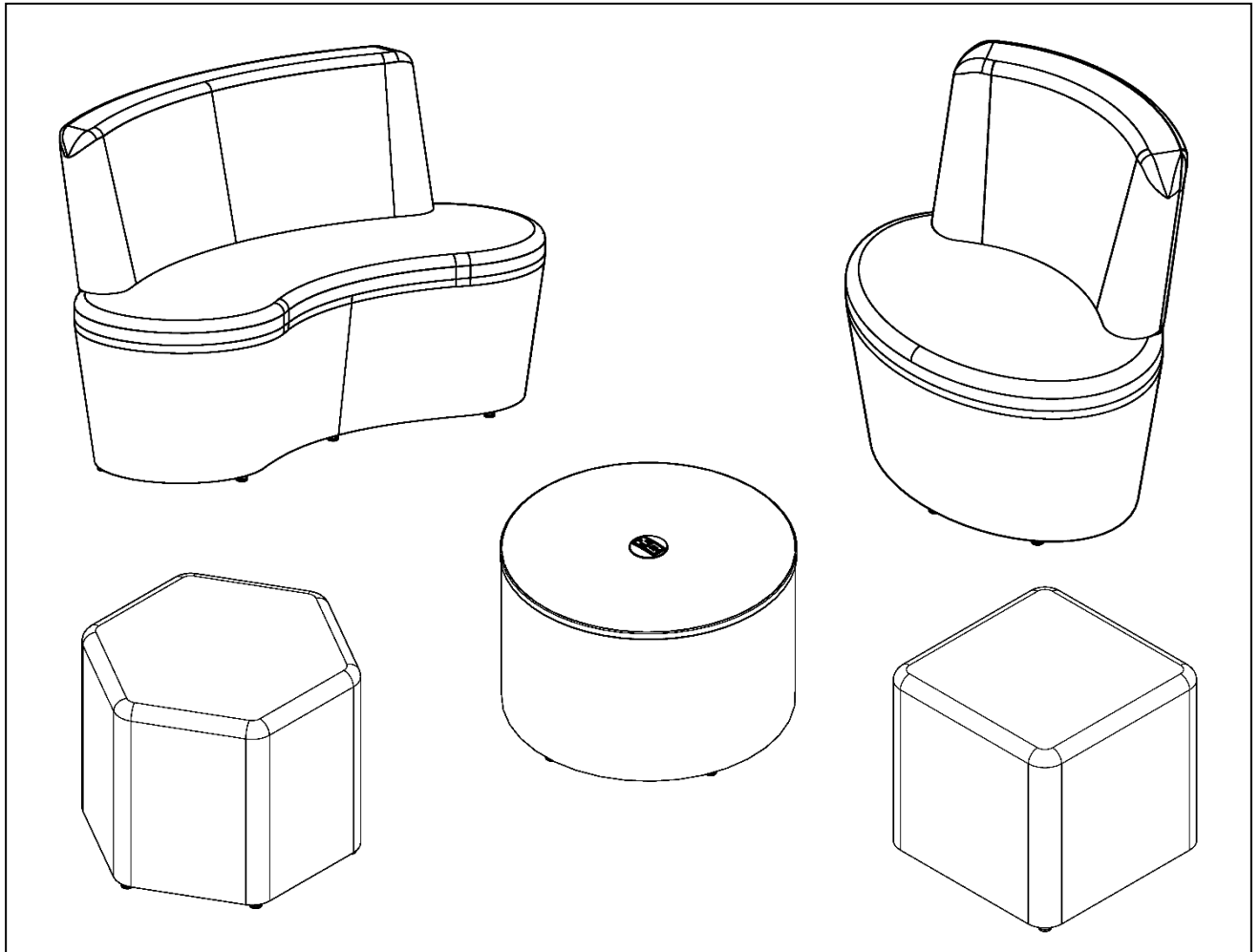

If you have damaged or missing components,
please contact customer service at 1-800-328-1061

Hardware and Components

(PN: 60135)

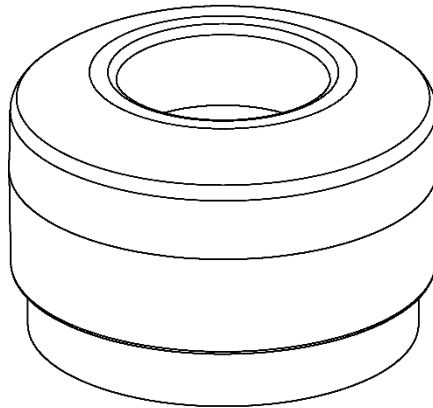

NYLON & FELT REVERSIBLE GLIDE
QTY. 6

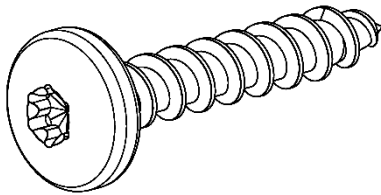

**#10 X 1-1/8" TORX HEAD
WOOD SCREW**
QTY. 6

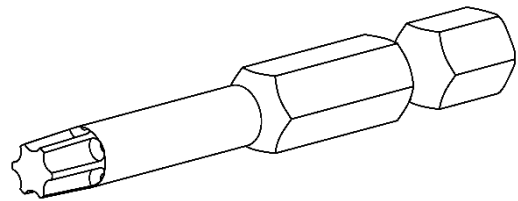

T25 TORX BIT
QTY. 1

Special Notes:

- TOOLS REQUIRED:
 - Drill w/ T25 Torx driver bit (bit provided)
- Check that all components are accounted for and undamaged before assembling.
- Please assemble the product in a clean and dry area.
- You may need another person to help assemble the product. Team lifting may be required.
- Clean the product with a mild cleaner and a damp cloth.
- Replacement Hardware Pack: 60135-R

Assembly Instructions

1. Flip the soft seating unit over on to a clean smooth surface that will not harm the fabric. On the underside of the unit there are marked spots along the perimeter where the glides should be installed.

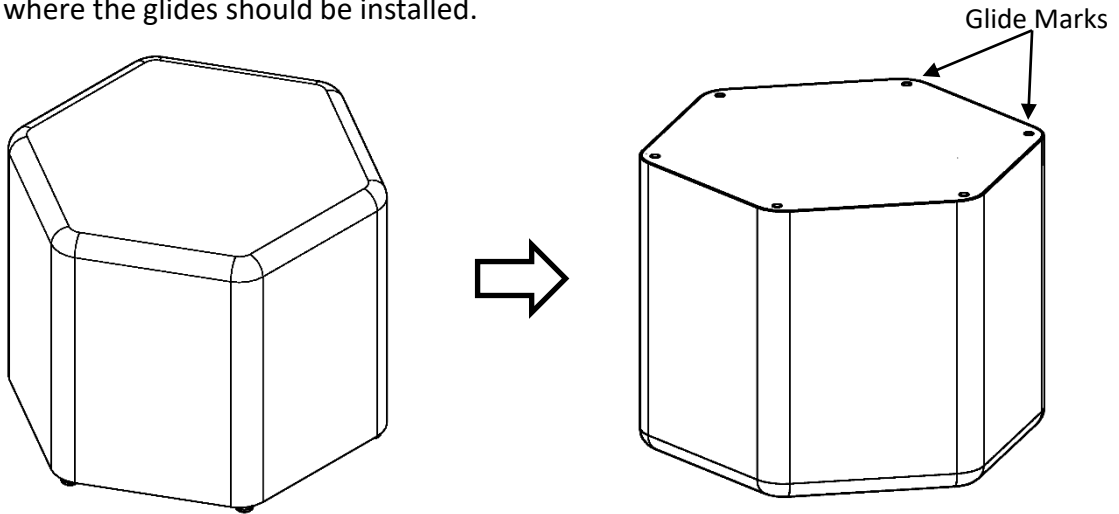

2. **FOR 55010 & 55011 UNITS ONLY:** Use a table to flip the chair onto the surface and push the back of the chair against the edge of the table. Make sure that the table is sufficiently tall so that the back of the chair does not touch the floor. **The chair may be heavy; team lifting is encouraged.** The marks around the perimeter are for the glides, the eight marks in the middle are for the optional Caster Outriggers.

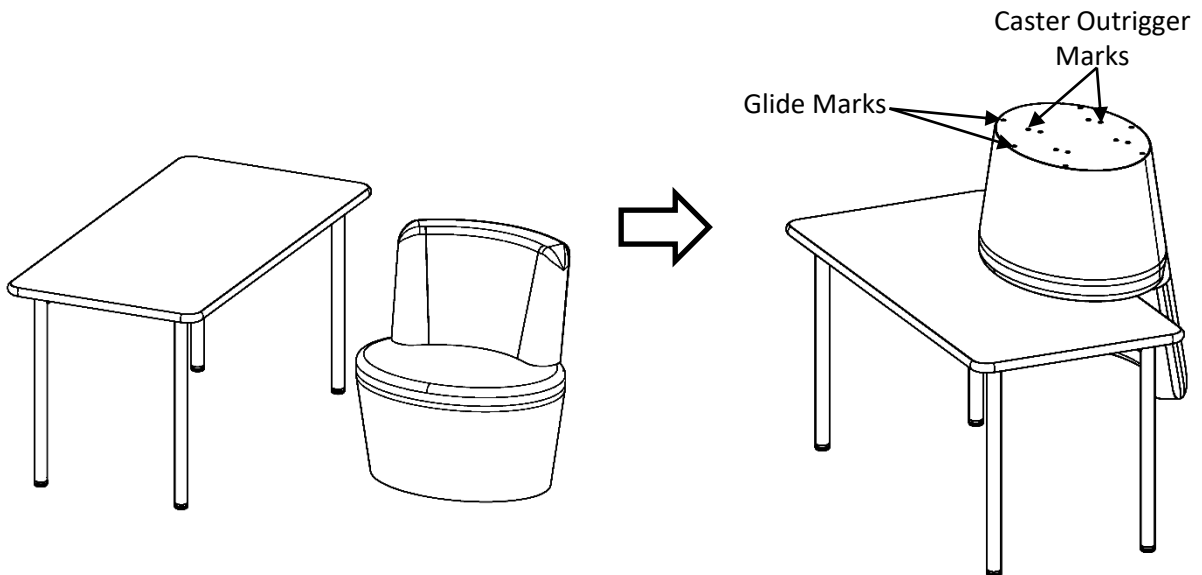

3. The glides can be installed either as nylon or felt glides. Shown on the left is how to install the screw into the glide if you want the nylon side down, and on the right is how to install the screw if you want the felt side down.

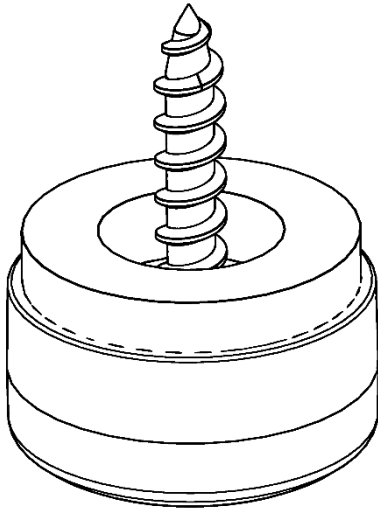

Nylon Position

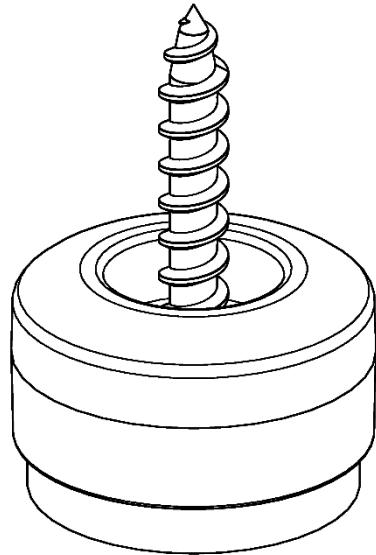

Felt Position

4. Install the #10 X 1-1/8" Torx Wood Screw into the glide in the position you would prefer (nylon or felt) and then install them into the unit in the marks around the perimeter with the provided T25 Torx Bit.

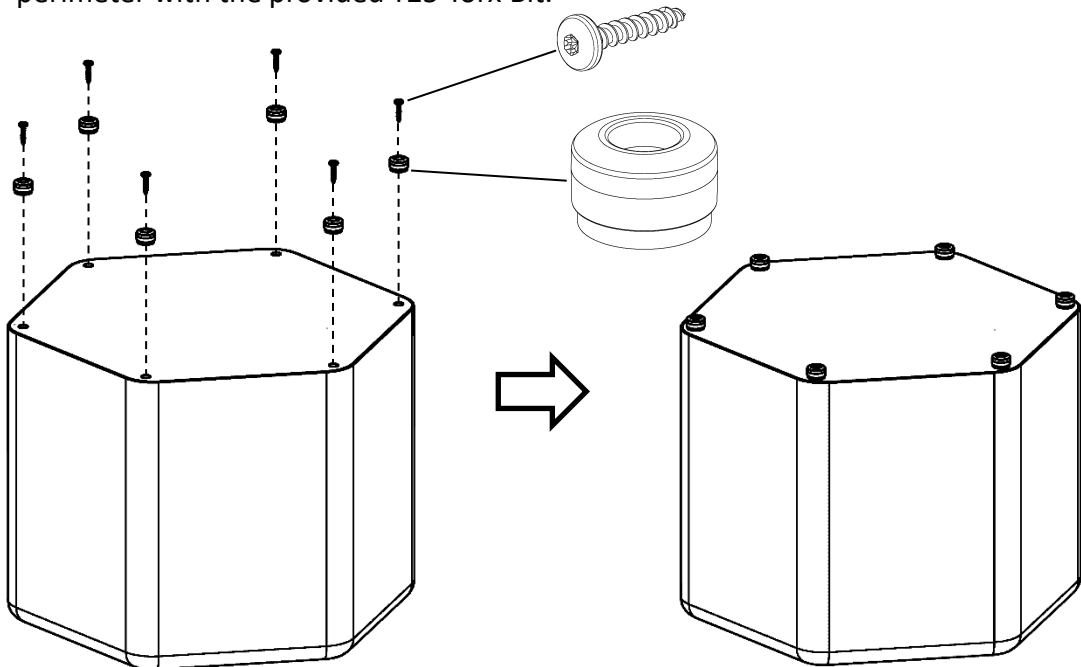

5. Flip unit over.

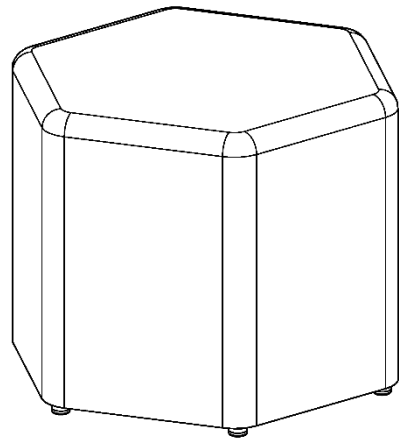
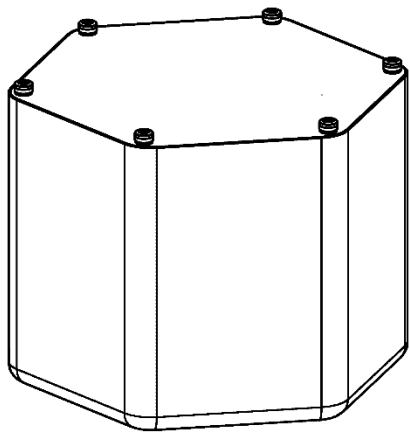

OR

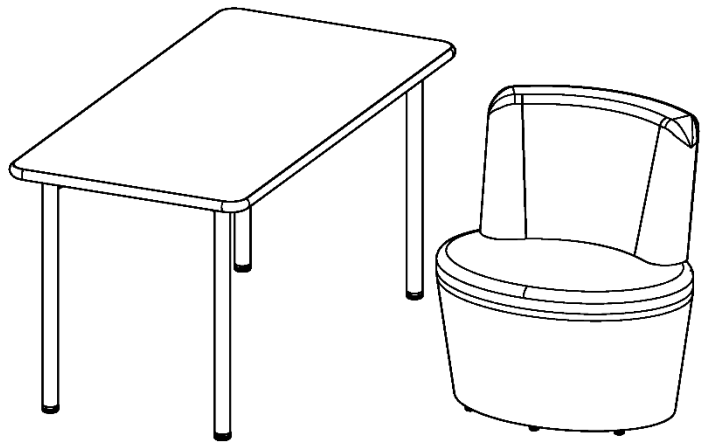
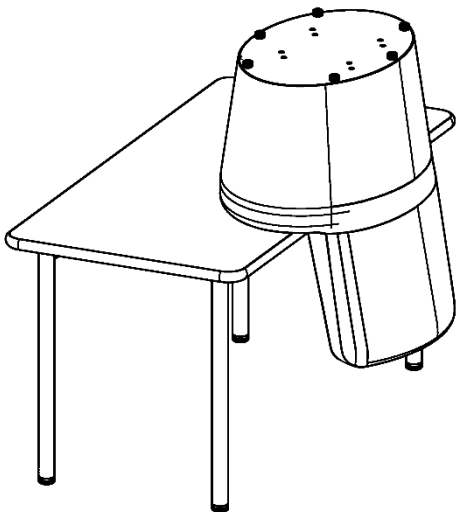

ASSEMBLY COMPLETE